

Lancia Delta HF Integrale Rear Bumper Removal

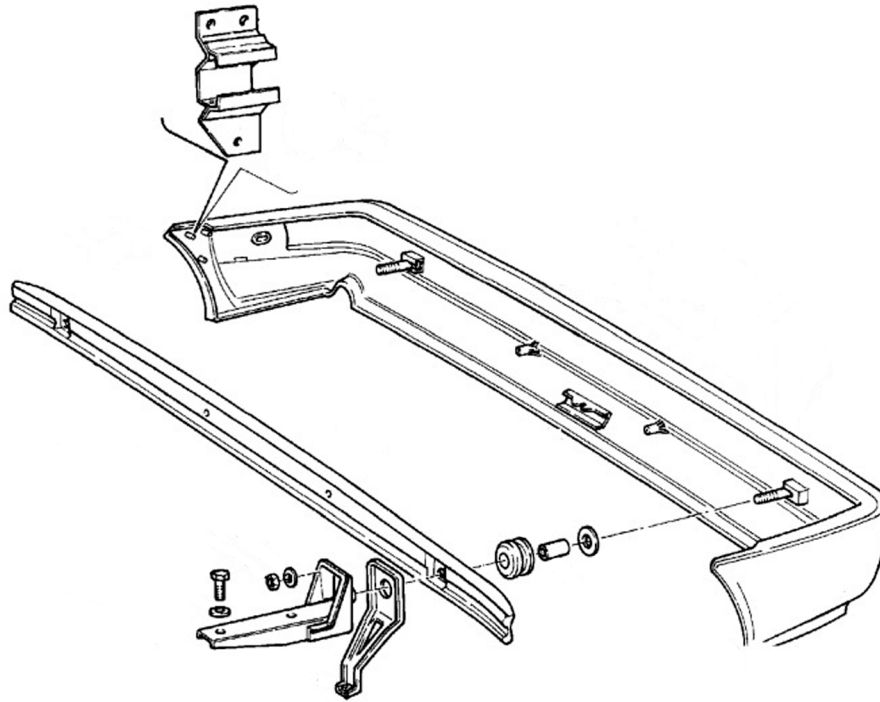

Overview

The rear bumper assembly is attached to the car through two bars that slide into the body and are bolted into place. The corners of the bumper are located by sliders attached to the body that are inserted into guides on the bumper.

Note that unlike most current cars, the bumper cover is attached to the bumper in a manner that it should be removed with the bumper and not removed in order to access the bumper to remove the bumper.

Removal

1. Remove (or move) the carpeted side panels on each side of the rear compartment to access the bumper bolts.
 - a. Remove the two screws holding each panel in place. One screw is in the top center, under the sides of the rear shelf. The other screw is at the top rear and holds a small panel at that corner.
 - b. Remove the strut top cover.
 - c. Release the rear of the panel from the seal for the hatch.
 - d. Pull the panel out to reveal the bolts that hold the bumper onto the car. The bolts go through the floor of the rear compartment.
2. Remove the bolts holding the bumper onto the car.

Each side is held on my two bolts. The heads of the bolts is 17mm. Wiring for the taillights may need to be moved to access the bolts.

3. Loosen the screw at the center of the bumper.

A plastic fitting and screw help locate the center of the bumper cover. It can be found above the hook that comes through the center of the bumper.

4. Pull the bumper off.

Pull back each corner to loosen the slider in its guide as well as the bars that slide into the body. Once those points are loose, pull the bumper to the rear until the bars have cleared the body. It would be helpful to have an assistant, but not necessary.

Installation

Reverse the removal instruction to install. Start by inserting the bars from the bumper into the body. Continue moving the bumper forward onto the body. As the corner guides approach the sliders on the body, make sure each guide goes onto its slider. Continue until the holes in the bars are aligned with the corresponding holes in the body. The bumper may slide onto the screw on the underside center or it may not quite reach the screw. Install the bolts and torque to 30 Nm (22 lb-ft). Put the rear compartment interior panels and its fasteners back into place.